

PARKING SCHEDULE FOR WESTERN BASEMENT ONLY	
CAR PARKING	89
DISABLED CAR PARKING	5
MOTORCYCLE PARKING	9
LONG-STAY CYCLE PARKING	550
SHORT-STAY CYCLE PARKING	-
SHORT-STAY DISABLED CYCLE PARKING	14

© COPYRIGHT OF THIS DRAWING IS RESERVED BY DBFL CONSULTING ENGINEERS. NO PART SHALL BE REPRODUCED OR TRANSMITTED WITHOUT THEIR WRITTEN PERMISSION.

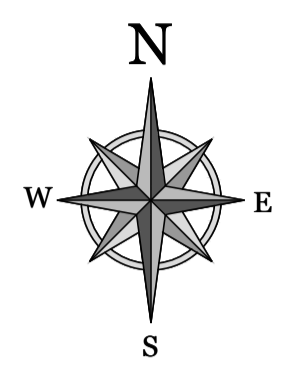
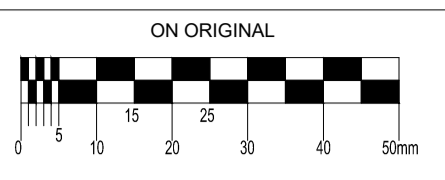

- NOTES:
- ALL WORKS TO BE CONSTRUCTED IN ACCORDANCE WITH THE NRA SPECIFICATION FOR ROAD WORKS UNLESS OVERRIDDEN BY SOUTH DUBLIN COUNTY COUNCIL STANDARDS.
  - ALL ROAD MARKINGS & SIGNS SHALL COMPLY FULLY WITH THE TRAFFIC SIGNS MANUAL, PUBLISHED BY THE DEPARTMENT OF TRANSPORT, AUGUST 2019.
  - SIGNS & MARKINGS: CONTRACTOR TO CONFIRM PRECISE SETTING OUT WITH EMPLOYERS REPRESENTATIVE PRIOR TO COMPLETION.
  - ALL SIGNS TO BE MOUNTED ON 75mm GALVANISED STEEL POSTS WITH COLOURED SLEEVES U.N.O. TO SPECIFICATION AND IN ACCORDANCE WITH THE TRAFFIC SIGNS MANUAL. MOUNTING HEIGHT TO BOTTOM OF SIGN = 2.3m U.N.O.
  - ALL TRAFFIC MANAGEMENT TO COMPLY FULLY WITH THE PROVISIONS OF CHAPTER 8 OF THE TRAFFIC SIGNS MANUAL.
  - ALL CO-ORDINATES ARE TO ITM
  - ALL LEVELS ARE TO ORDNANCE DATUM AND ARE IN METRES
  - ALL PEDESTRIAN, CYCLE AND VEHICULAR ROUTES MUST BE RETAINED IN ACCORDANCE WITH APPROVED TRAFFIC MANAGEMENT PLAN.
  - ALL MATERIALS TO BE DISPOSED OFF SITE SHALL BE TAKEN TO A LICENSED FACILITY APPROVED BY DUBLIN CITY COUNCIL.
  - UNLESS OTHERWISE IDENTIFIED ALL KERBS ARE 80mm HIGH

LEGEND

- SITE BOUNDARY
- BUILDING OUTLINE
- PROPOSED BASEMENT ROADWAY
- PROPOSED RAMP CYCLE LANE
- PROPOSED CYCLE LANE
- ROAD WIDTH
- EXISTING ROAD LEVELS
- PROPOSED ROAD LEVELS

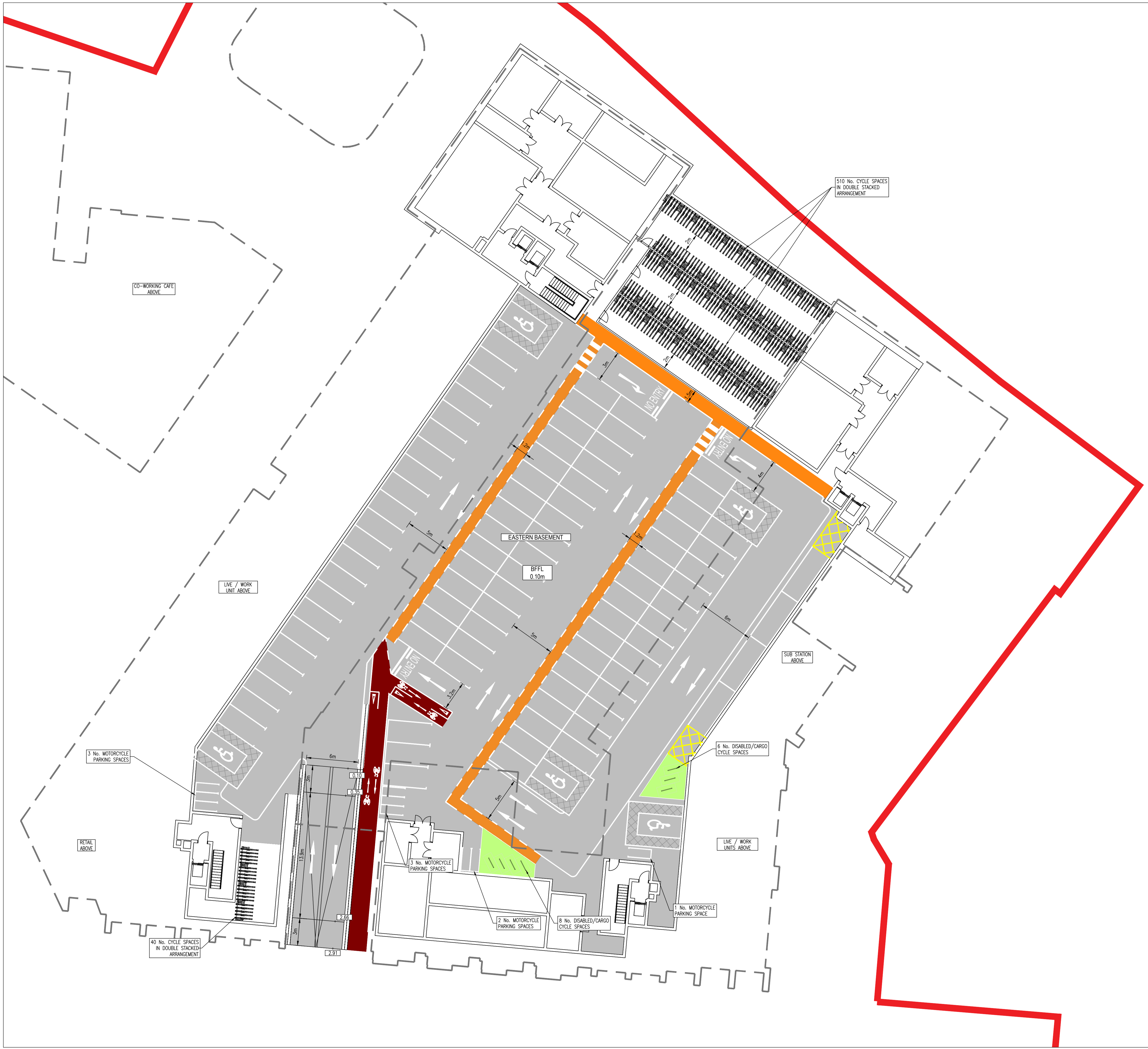

rev	date	description	by	chkd.
P02	02-12-20	PLANNING	BS	NJF
P01	12-12-19	Planning	BS	NJF

client approval: A - Approved, B - Approved with comments, C - Do not use

suitability: S2 - INFORMATION, issue purpose: PLANNING

**DBFL Consulting Engineers**  
Civil, Structural & Transportation Engineering  
www.dbfl.ie

DUBLIN OFFICE: Ormond House, Upper Ormond Quay, Dublin 7, D07 W704  
PHONE: +353 1 450 4000  
CORK OFFICE: Phoenix House, Monahan Road, Cork, T12 H1KX  
PHONE: +353 (0) 21 2254538  
WATERFORD OFFICE: Suite 10 The Arkum, Maritime Gate, Canada Street, Waterford, X91 W028  
PHONE: +353 51 309 500

project ref:			
CASTLEFORBES DEVELOPMENT			
drawing title:			
EASTERN BASEMENT LAYOUT			
client:			
GLENVEAGH			
designed by:	author:	scale:	sheet size:
NJF	BS	1:200	A1
drawing no.:	180159-2102		revision:
			P02